



FSI
FASTENING SYSTEMS
INTERNATIONAL

PT-4500 Cordless Blind Riveter for **CHERRYMAX®** & Blind Bolts

POWERFUL

VERSATILE

LIGHTWEIGHT

PRODUCTIVE



Specifications for PT-4500:

Pulling Force:	5,000 lbs.
Stroke:	0.984"
Dimensions:	11.5" H x 12" L x 3.25" W
Power Source:	2.1 Ah, 18vdc Li-Ion Battery
Charger Source:	Dual Voltage 120 volt, 60Hz 220 volt, 50 Hz
Charger Cycle Time:	40 Minutes
Optimal Operating Temp.	50 to 122°F
Housing Material:	Impact Resistant Glass Filled Nylon

The New, Higher Capacity PT-4500 Cordless Blind Riveter offers the sheet metal technician capability for installation of most all 1/4" diameter blind rivets while retaining all the features of the PT-4000 with respect to size, weight and versatility.

Powered by a slide on 18 VDC Li-Ion battery pack with fuel gage, the PT-4500 brushless motor drives a mechanical ball screw gear system that provides capability for the most demanding applications. With its rapid extended stroke capability the tool is comparable to most all air operated riveters, thereby optimizing cycle time between any blind rivet installation. Weighing less than 5 lbs with the standard nose assembly in place, sheet metal artisans will immediately find this riveter to offer the ultimate in overall performance and reliability.

The PT-4500 Kit includes the tool, 1 each battery pack and dual voltage battery charger.



Contract #
 GS-06F-0009L

PO Box 1372 • 1206 East Macarthur St. Sonoma, CA 95476 • 800-344-2393
(707) 935-1170 • Fax: (707) 935-1828 • www.fsirivet.com • sales@fsirivet.com

PT-4500 (optional) Configurations

Standard Configuration

Nosepiece

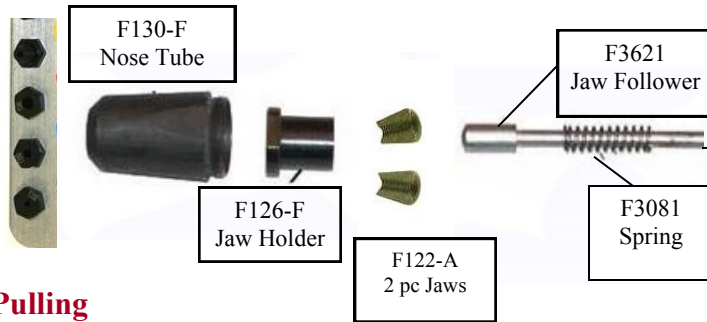

CherryMax® Pulling Head Configuration

Extended Straight Pulling Head F1074

Right Angle Pulling Head F1075

Offset Pulling Head F1076

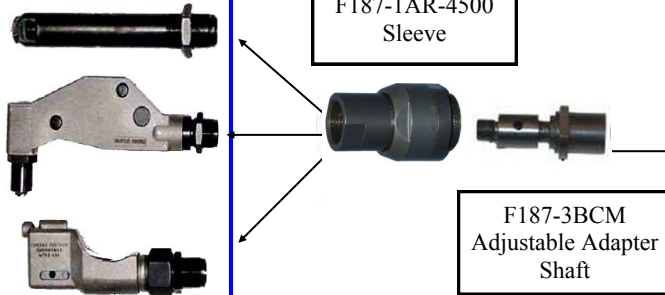

CherryMax® & Pop® Rivets Configuration

*Note: Replace Jaw Follower F3621 with F3245 (see spare parts canister) when installing 1/4" dia. rivets. You may also use the F123 (3pc) jaws for 1/8" thru 1/4" diameter blind rivets. Use F142 Nosepiece.

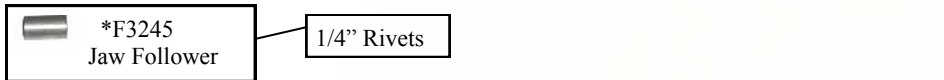

MS90353/54 "U" & "S" Type Blind Bolt Configuration

Nosepiece

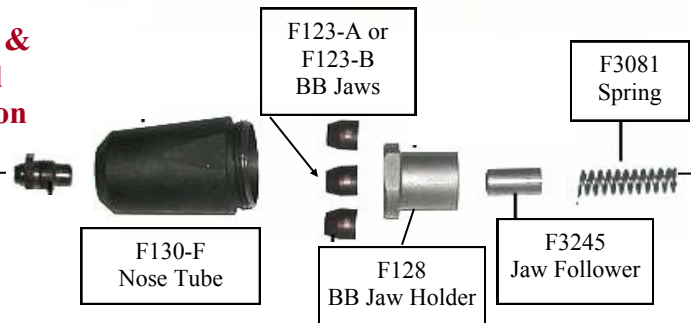

Rivet Types:

Types of rivets installable with the PT-4500 include, but are not limited to, virtually all CherryMax®(M7885), Avdel®, or Cherry Monobolts®, Cherry Interlock®, Huck MagnaLok®, and Pop type rivets. The PT-4500 is also capable of installing both 5/32" and 3/16" Blind Bolts (MS90353/54-S/U) with the proper nosepieces (provided in the Mil-1 and MIL-2 kits).



Spare Parts:

F-4500A Battery Pack 18 v Battery Pack
 F-3500A Battery Charger Dual Voltage 110/220

Aerospace and Industrial Sheet Metal
•Applications•