

Blind Rivets

GESIPA[®]



*The Experts
in Blind Riveting*

ABOUT THE COMPANY

GESIPA was established in Walldorf, Germany in 1955, as a company committed to developing better blind riveting technologies. Today, GESIPA has manufacturing facilities around the world including the United States, Germany, England, Poland and Brazil. The driving force behind GESIPA's international success has been the ongoing development of innovative products that enhance productivity through superior engineering and quality workmanship. In 1975, GESIPA revolutionized blind riveting with the introduction of the **GAV Automatic-Feed Blind Riveting System**. GAV systems have set the standard for blind riveting efficiency. GESIPA installation tools are known for their high quality, durability and functional design. From the **Flipper**, our low effort manual-riveting tool, to the revolutionary **AccuBird**, **PowerBird** & **FireBird**, battery powered portable tools, GESIPA's innovation stands clear. Over the years, GESIPA has made strategic acquisitions to expand the range of blind rivet products offered. In 1990, GESIPA purchased the commercial division of Olympic Fastening Systems, adding the **Bulb-tite** and **Mega-Grip** structural blind rivets. Through it all, GESIPA is committed to maintaining a leadership role in providing industry with cost-effective fastening solutions.

HOW BLIND RIVETS WORK

The standard blind break-mandrel rivet is comprised of two components, a rivet body and mandrel. The rivet is first placed into an installation tool and is then inserted into the application. Activating the tool pulls the rivet's mandrel, drawing the mandrel head into the blind-end of the rivet body. This action forms an upset head on the rivet body and securely clamps the application materials together. Finally, the mandrel reaches its predetermined break-load, with the spent portion of the mandrel breaking away and being removed from the set rivet. Fast, easy-to-use blind rivets offer speed of assembly, consistent mechanical performance and excellent installed appearance, making blind riveting a reliable and economical assembly method.

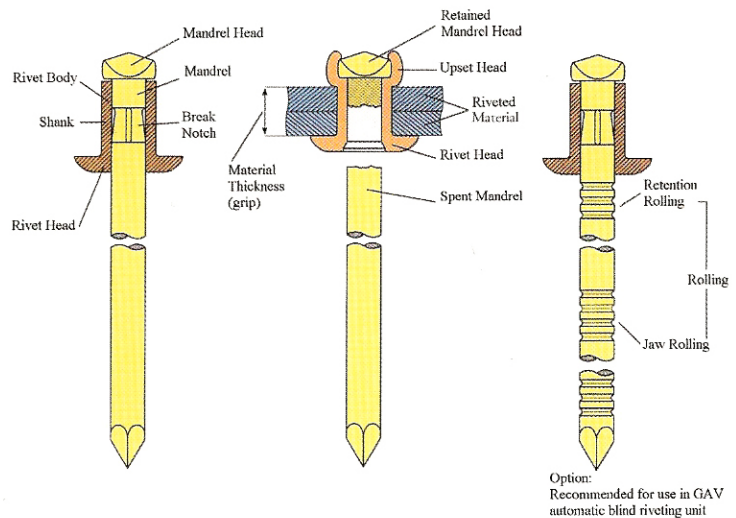

The graph illustrates the mechanical function of a blind break-mandrel rivet during installation.

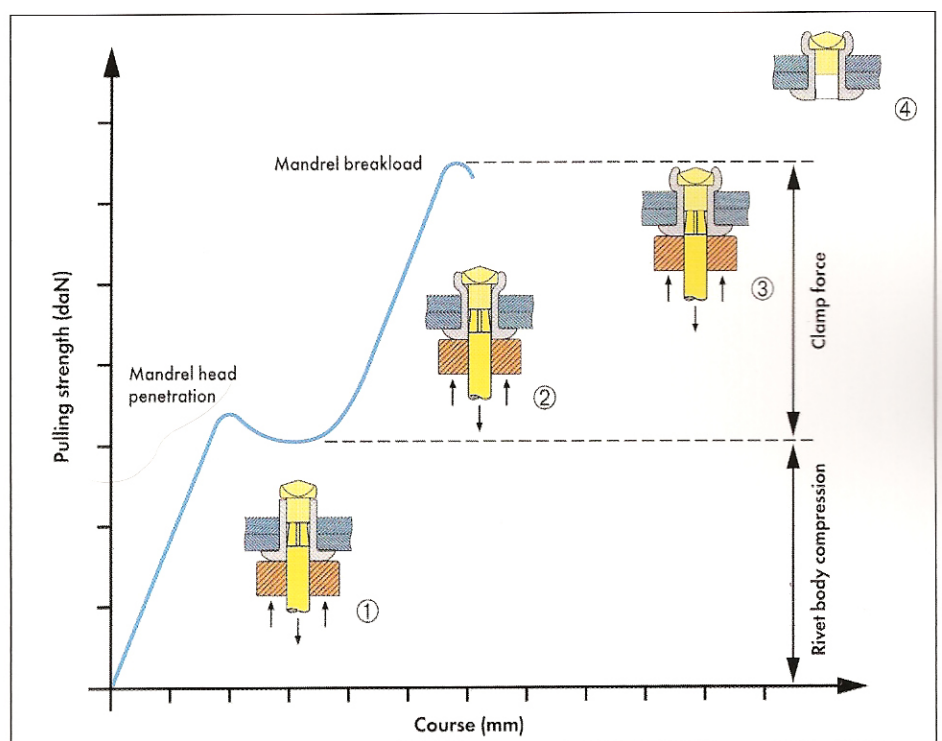

AMERICAN STANDARD BLIND RIVET IFI 114

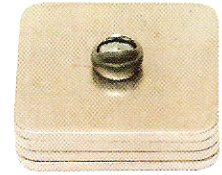
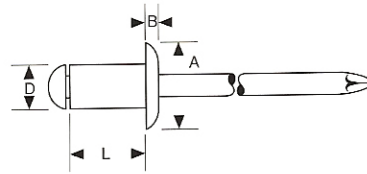

ECONOMICAL: GESIPA American Standard open-end blind rivets are economical to use, providing low costs and higher installation efficiency when compared to other fastening methods.

VERSATILE: American Standard open-end blind rivets are available in three head styles: Dome, Large Flange and Countersunk, to satisfy your application requirements.

SELECTION: Material choices include: Aluminum Rivet/Aluminum Mandrel, Aluminum Rivet/Steel Mandrel, Steel Rivet/Steel Mandrel, Stainless Rivet/Steel Mandrel and Stainless Rivet/Stainless Mandrel. Special finishes such as paint, anodized or non-standard plating are available and quoted upon request.

QUALITY: GESIPA American Standard open-end blind rivets are made in accordance with IFI 114 standards for dimensional, material and mechanical performance specifications.

Aluminum Rivet/Aluminum Mandrel - IFI 114 Grade 11

Head Style	Rivet Dia. Nom.	GESIPA Part Number	Grip Range (inch)	Hole Size Drill No.	Dimensions (Inches)				Min. Strength (lbs.)	
					D	B Max.	A	L Max.	Shear	Tensile
Dome	1/8"	GAMD41A	.020-.062	.129-.133 #30	.122-.128	.040	.238-.262	.212	120	150
		GAMD42A	.063-.125					.275		
		GAMD43A	.126-.187					.337		
		GAMD44A	.188-.250					.400		
		GAMD45A	.251-.312					.462		
		GAMD46A	.313-.375					.525		
	GAMD48A	.376-.500	.650							
	5/32"	GAMD52A	.020-.125	.160-.164 #20	.153-.159	.050	.296-.328	.300	190	230
		GAMD53A	.126-.187					.362		
		GAMD54A	.188-.250					.425		
		GAMD56A	.251-.375					.550		
		GAMD58A	.376-.500					.675		
		3/16"	GAMD62A					.020-.125		
	GAMD64A		.126-.250	.450						
	GAMD66A		.251-.375	.575						
	GAMD68A		.376-.500	.700						
GAMD610A	.501-.625		.825							
GAMD612A	.626-.750		.950							
GAMD614A	.751-.875		1.075							
GAMD616A	.876-1.00		1.200							
1/4"	GAMD84A	.126-.250	.257-.261 "F"	.246-.255	.080	.475-.525	.500	460	560	
	GAMD86A	.251-.375					.625			
	GAMD88A	.376-.500					.750			
	GAMD810A	.501-.625					.875			
	GAMD812A	.626-.750					1.000			
	GAMD816A	.751-1.00					1.250			

AMERICAN STANDARD BLIND RIVET IFI 114

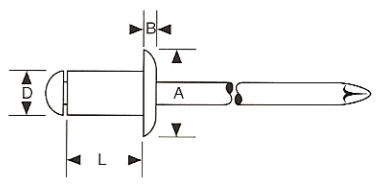

DOME

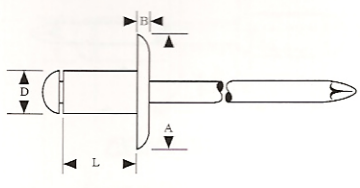

LARGE FLANGE

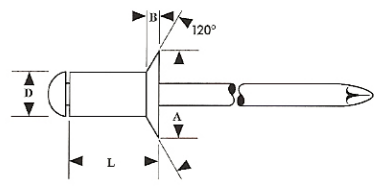

COUNTERSUNK

Aluminum Rivet/Aluminum Mandrel - IFI 114 Grade 11

Head Style	Rivet Dia. Nom.	GESIPA Part Number	Grip Range (Inches)	Hole Size Drill No.	Dimensions (Inches)				Min. Strength (lbs.)	
					D	B Max.	A	L Max.	Shear	Tensile
Large Flange	1/8"	GAML42A	.063-.125	.129-.133 #30	.122-.128	.065	.360-.390	.275	120	150
		GAML44A	.126-.250					.400		
		GAML46A	.251-.375					.525		
	3/16"	GAML64A	.126-.250	.192-.196 #11	.183-.191	.092	.600-.650	.450	260	320
GAML66A		.251-.375	.575							
GAML68A		.376-.500	.700							
GAML610A		.501-.625	.825							
GAML612A		.626-.750	.950							
Countersunk	1/8"	GAMC42A	.092-.125	.129-.133 #30	.122-.128	.031	.207-.233	.275	120	150
		GAMC43A	.126-.187					.337		
		GAMC44A	.188-.250					.400		
		GAMC45A	.251-.312					.462		
	5/32"	GAMC54A	.188-.250	.160-.164 #20	.153-.159	.040	.268-.294	.425	190	230
		GAMC56A	.251-.375					.550		
3/16"	GAMC64A	.188-.250	.192-.196 #11	.183-.191	.050	.355-.361	.450	260	320	

Part Number Identification

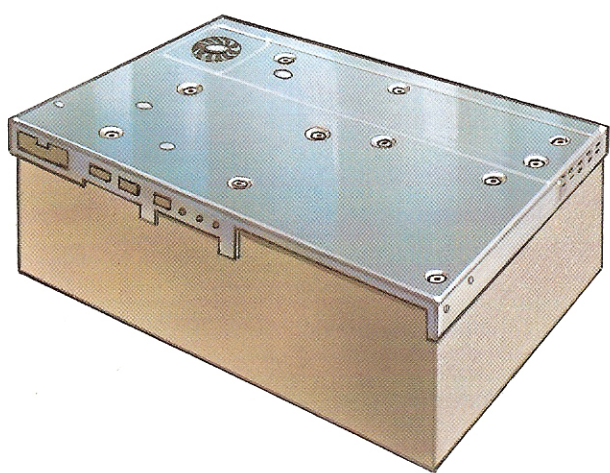

Standard blind rivets are a cost-effective method for assembling metal chassis applications — offering speed, consistency and reliability

AMERICAN STANDARD BLIND RIVET IFI 114

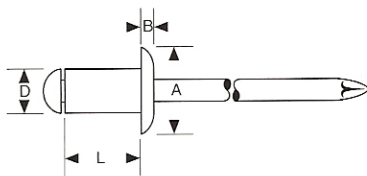

DOME

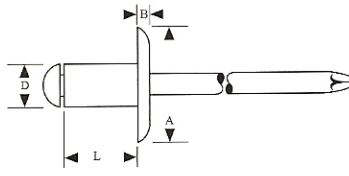

LARGE FLANGE

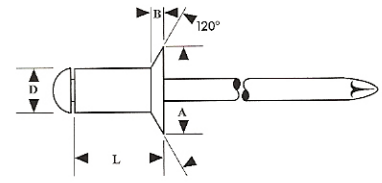

COUNTERSUNK

Aluminum Rivet/Steel Mandrel - IFI 114 Grade 19

Head Style	Rivet Dia. Nom.	GESIPA Part Number	Grip Range (Inches)	Hole Size Drill No.	Dimensions (Inches)				Min. Strength (lbs.)								
					D	B Max.	A	L Max.	Shear	Tensile							
Dome	1/8"	GSMD41A	.020-.062	.129-.133 #30	.122-.128	.040	.238-.262	.212	170	220							
		GSMD42A	.063-.125					.275									
		GSMD43A	.126-.187					.337									
		GSMD44A	.188-.250					.400									
		GSMD45A	.251-.312					.462									
		GSMD46A	.313-.375					.525									
	5/32"	GSMD52A	.020-.125	.160-.164 #20	.153-.159	.050	.296-.328	.300	260	350							
		GSMD53A	.126-.187					.362									
		GSMD54A	.188-.250					.425									
		GSMD56A	.251-.375					.550									
		GSMD58A	.376-.500					.675									
		3/16"	GSMD62A					.020-.125			.192-.196 #11	.183-.191	.060	.356-.394	.325	380	500
	GSMD64A		.126-.250	.450													
	GSMD66A		.251-.375	.575													
	GSMD68A		.376-.500	.700													
	GSMD610A		.501-.625	.825													
GSMD612A	.626-.750		.950														
GSMD614A	.751-.875		1.075														
GSMD616A	.876-1.00		1.200														
1/4"	GSMD84A	.126-.250	.257-.261 "F"	.246-.255	.080	.475-.525	.500	700	920								
	GSMD86A	.251-.375					.625										
	GSMD88A	.376-.500					.750										
	GSMD810A	.501-.625					.875										
	GSMD812A	.626-.750					1.000										
	GSMD816A	.751-1.00					1.250										
	Large Flange	1/8"					GSML42A			.063-.125	.129-.133 #30	.122-.128	.065	.360-.390	.275	170	220
							GSML44A			.126-.250					.400		
GSML46A			.251-.375	.525													
3/16"		GSML64A	.126-.250	.192-.196 #11	.183-.191	.092	.600-.650	.450	380	500							
		GSML66A	.251-.375					.575									
		GSML68A	.376-.500					.700									
Countersunk	1/8"	GSMD42A	.092-.125	.129-.133 #30	.122-.128	.031	.207-.233	.275	170	220							
		GSMD43A	.126-.187					.337									
		GSMD44A	.188-.250					.400									
		GSMD45A	.251-.312					.462									
	5/32"	GSMD54A	.188-.250	.160-.164 #20	.153-.159	.040	.268-.294	.425	260	350							
		GSMD56A	.251-.375					.550									
	3/16"	GSMD64A	.188-.250	.192-.196 #11	.183-.191	.050	.335-.361	.450	380	500							

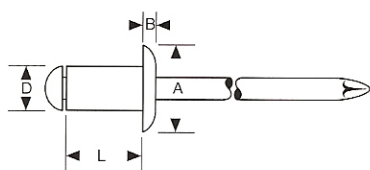

DOME

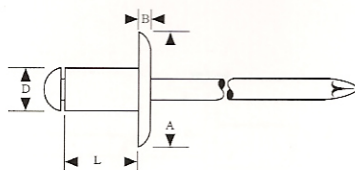

LARGE FLANGE

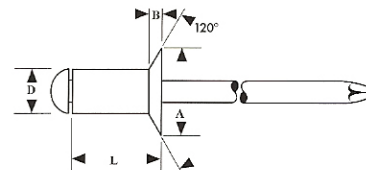

COUNTERSUNK

Steel Rivet/Steel Mandrel - IFI 114 Grade 30

Head Style	Rivet Dia. Nom.	GESIPA Part Number	Grip Range (Inches)	Hole Size Drill No.	Dimensions (Inches)				Min. Strength (lbs.)								
					D	B Max.	A	L Max.	Shear	Tensile							
Dome	1/8"	GSMD41S	.020-.062	.129-.133 #30	.122-.128	.040	.238-.262	.212	260	310							
		GSMD42S	.063-.125					.275									
		GSMD43S	.126-.187					.337									
		GSMD44S	.188-.250					.400									
		GSMD45S	.251-.312					.462									
		GSMD46S	.313-.375					.525									
	GSMD48S	.376-.500	.650														
	5/32"	GSMD52S	.020-.125	.160-.164 #20	.153-.159	.050	.296-.328	.300	370	470							
		GSMD53S	.126-.187					.362									
		GSMD54S	.188-.250					.425									
		GSMD56S	.251-.375					.550									
		GSMD58S	.376-.500					.675									
		3/16"	GSMD62S					.020-.125			.192-.196 #11	.183-.191	.060	.356-.394	.325	540	680
	GSMD64S		.126-.250	.450													
	GSMD66S		.251-.375	.575													
	GSMD68S		.376-.500	.700													
GSMD610S	.501-.625		.825														
GSMD612S	.626-.750		.950														
GSMD614S	.751-.875		1.075														
GSMD616S	.876-1.00		1.200														
1/4"	GSMD84S	.126-.250	.257-.261 "F"	.246-.255	.080	.475-.525	.500	1000	1240								
	GSMD86S	.251-.375					.625										
	GSMD88S	.376-.500					.750										
	GSMD810S	.501-.625					.875										
	GSMD812S	.626-.750					1.000										
	GSMD814S	.751-.875					1.125										
	GSMD816S	.876-1.00					1.250										
	Large Flange	1/8"					GSML42S			.063-.125	.129-.133 #30	.122-.128	.065	.360-.390	.275	260	310
GSML44S			.126-.250	.400													
GSML46S			.251-.375	.525													
5/32"		GSML54S	.020-.250	.160-.164 #20	.153-.159	.075	.448-.488	.425	370	470							
		3/16"	GSML64S					.126-.250			.192-.196 #11	.183-.191	.092	.600-.650	.450	540	680
			GSML66S					.251-.375							.575		
GSML68S	.376-.500		.700														
Countersunk	1/8"	GSML610S	.501-.625	.129-.133 #30	.122-.128	.031	.207-.233	.825	260	310							
		GSML612S	.626-.750					.950									
		GSML614S	.751-.875					1.075									
		GSML616S	.876-1.00					1.200									
	5/32"	GSML54S	.020-.250	.160-.164 #20	.153-.159	.040	.268-.294	.425	370	470							
		GSML56S	.251-.375					.550									
3/16"	GSML64S	.126-.250	.192-.196 #11	.183-.191	.050	.335-.361	.450	540	680								

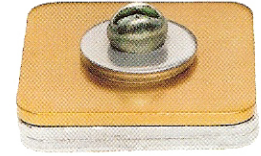

Back-Up Washers can be used in conjunction with GESIPA'S standard diameter rivets, where applications require a greater bearing surface on the blind side.

	Part Number	Shape	Inside Diameter	Outside Diameter
Aluminum	GARW-4	Round	1/8"	3/8"
	GARW-5	Round	5/32"	7/16"
	GARW-6	Round	3/16"	1/2"
Steel	GSRW-4	Round	1/8"	3/8"
	GSRW-6	Round	3/16"	1/2"

G A R W - 4

GESIPA ———

Type Material ———

(A-Aluminum)

(S-Steel) Style ———

(R-Round)

—————

Inside Diameter (in 1/32")

—————

Washer

PLASTIC BLIND RIVETS

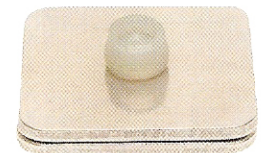
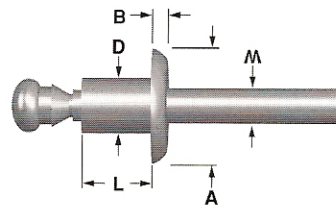
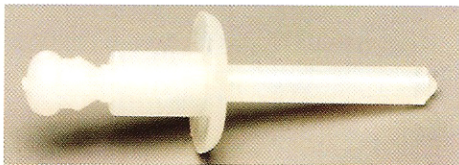

GESIPA All Plastic Blind rivets join many types of plastics and other materials such as wood, metal, fiberglass, plexiglass, synthetic insulating materials, etc.

Head Style	Rivet Dia. Nom.	GESIPA Part Number	Grip Range mm (Inches)	Hole Size mm (Inches)	Dimensions (Millimeters)					Ult. Shear Newtons (lbs.)
					D	B Max.	A	L Max.	M	
Dome	4.0	4 x 8F Plastic	0.5-5.0 (.020-.197)	4.1 (.160-.164) Drill #20	3.9-4.08	1.4	8.8-9.2	9.0	2.5	180N (40 lbs.)
		4 x 12F Plastic	5.0-9.0 (.197-.354)	13.0						
	5.0	5 x 8F Plastic	0.5-5.0 (.020-.197)	5.1 (.200-.204) Drill #7	4.9-5.08	1.8	10.7-11.3	9.0	3.0	290N (65 lbs.)
		5 x 12F Plastic	5.0-9.0 (.197-.354)	13.0						
	6.0	6 x 8F Plastic	0.5-5.0 (.020-.197)	6.1 (.241-.245) Drill "C"	5.9-6.08	1.8	12.7-13.3	9.0	3.5	440N (100 lbs.)
		6 x 12F Plastic	5.0-9.0 (.197-.354)	13.0						

AMERICAN STANDARD BLIND RIVET IFI 114

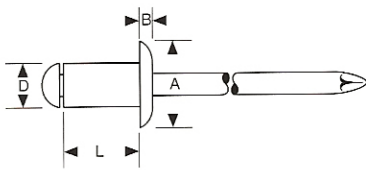

DOME

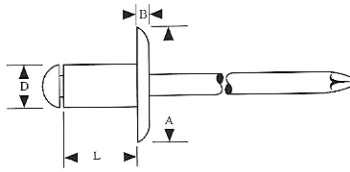

LARGE FLANGE

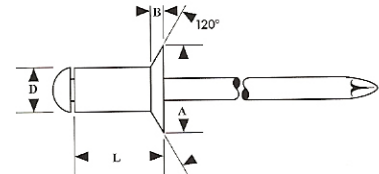

COUNTERSUNK

Stainless Rivet/Steel Mandrel - IFI 114 Grade 50

Head Style	Rivet Dia. Nom.	GESIPA Part Number	Grip Range (Inches)	Hole Size Drill No.	Dimensions (Inches)				Min. Strength (lbs.)	
					D	B Max.	A	L Max.	Shear	Tensile
Dome	1/8"	GSMD42SS	.020-.125	.129-.133 #30	.122-.128	.040	.238-.262	.275	420	530
		GSMD43SS	.126-.187					.337		
		GSMD44SS	.188-.250					.400		
		GSMD46SS	.251-.375					.525		
		GSMD48SS	.376-.500					.650		
5/32"	GSMD52SS	.020-.125	.160-.164 #20	.153-.159	.050	.296-.328	.300	650	820	
		GSMD54SS					.126-.250			.425
		GSMD56SS					.251-.375			.550
3/16"	GSMD62SS	.020-.125	.192-.196 #11	.183-.191	.060	.356-.394	.325	950	1200	
		GSMD64SS					.126-.250			.450
		GSMD66SS					.251-.375			.575
		GSMD68SS					.376-.500			.700

Stainless Rivet/Stainless Mandrel - IFI 114 Grade 51

Head Style	Rivet Dia. Nom.	GESIPA Part Number	Grip Range (Inches)	Hole Size Drill No.	Dimensions (Inches)				Min. Strength (lbs.)	
					D	B Max.	A	L Max.	Shear	Tensile
Dome	1/8"	GSSMD42SS	.020-.125	.129-.133 #30	.122-.128	.040	.238-.262	.275	420	530
		GSSMD43SS	.126-.187					.337		
		GSSMD44SS	.188-.250					.400		
		GSSMD46SS	.251-.375					.525		
		GSSMD48SS	.376-.500					.650		
5/32"	GSSMD52SS	.020-.125	.160-.164 #20	.153-.159	.050	.296-.328	.300	650	820	
		GSSMD54SS					.126-.250			.425
		GSSMD56SS					.251-.375			.550
3/16"	GSSMD62SS	.020-.125	.192-.196 #11	.183-.191	.060	.356-.394	.325	950	1200	
		GSSMD64SS					.126-.250			.450
		GSSMD66SS					.251-.375			.575
		GSSMD68SS					.376-.500			.700

G S M D 3 2 S
 GESIPA _____
 Mandrel Material _____
 Head Style _____
 _____ Rivet Material
 _____ Grip Range (in 1/16")
 _____ Rivet Diameter (in 1/32")

Mandrel Material:
 A = Aluminum
 S = Steel
 SS = Stainless Steel
Head Styles:
 D = Dome
 L = Large Flange
 C = Countersunk

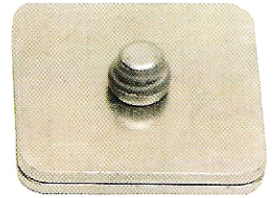
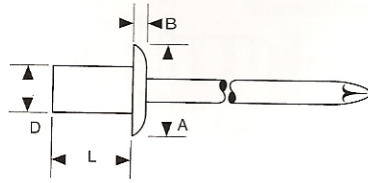

GESIPA CAP rivets provide the added security of a closed-end rivet body, preventing moisture and dirt from entering into an assembly through the rivet bore.

Aluminum Rivet/Steel Mandrel

Head Style	Rivet Dia. Nom.	GESIPA Part Number	Grip Range (Inches)	Hole Size Drill No	Dimensions (Inches)				Typical Strength (lbs.)	
					D	B Max.	A	L Max.	Shear	Tensile
Dome	1/8"	GSMD41AC	.032-.062	.129-.133 #30	.123-.129	.056	.224-.248	.254	240	280
		GSMD42AC	.063-.125					.317		
		GSMD43AC	.126-.187					.379		
		GSMD44AC	.188-.250					.442		
		GSMD45AC	.251-.312					.504		
		GSMD46AC	.313-.375					.567		
	5/32"	GSMD52AC	.063-.125	.160-.164 #20	.154-.160	.067	.303-.327	.337	350	480
		GSMD53AC	.126-.187					.399		
		GSMD54AC	.188-.250					.462		
	3/16"	GSMD62AC	.063-.125	.192-.196 #10	.186-.192	.079	.362-.384	.357	500	690
		GSMD64AC	.126-.250					.482		
		GSMD66AC	.313-.375					.607		
		GSMD68AC	.376-.500					.732		
		GSMD610AC	.501-.625					.857		

Aluminum Rivet/Aluminum Mandrel

Dome	1/8"	GAMD42AC	.063-.125	.129-.133 #30	.123-.129	.056	.224-.248	.317	100	110
		GAMD43AC	.126-.187					.379		
		GAMD44AC	.188-.250					.442		
	5/32"	GAMD54AC	.126-.250	.160-.164 #20	.154-.160	.067	.303-.327	.462	130	180
	3/16"	GAMD62AC	.063-.125	.192-.196 #11	.186-.192	.079	.362-.384	.357	210	250
		GAMD64AC	.126-.250					.482		
		GAMD66AC	.251-.375					.607		
		GAMD68AC	.376-.500					.732		

Stainless Rivet/Stainless Mandrel

Dome	1/8"	GSSMD42SSC	.063-.125	.129-.133 #30	.123-.129	.047	.227-.249	.317	450	560
		GSSMD43SSC	.126-.187					.379		
		GSSMD44SSC	.188-.250					.442		
	3/16"	GSSMD62SSC	.063-.125	.192-.196 #11	.186-.192	.075	.362-.384	.357	1,000	1,210
		GSSMD64SSC	.126-.250					.482		
		GSSMD66SSC	.251-.375					.607		

G S M D 4 2 A C

GESIPA _____
 Mandrel Material _____
 Head Style _____
 _____ Cap Rivet
 _____ Rivet Material
 _____ Grip Range (in 1/16")
 _____ Rivet Diameter (in 1/32")

Mandrel Material: S = Steel
Head Style: D = Dome
 A = Aluminum

EXTRA LENGTH METRIC RIVETS

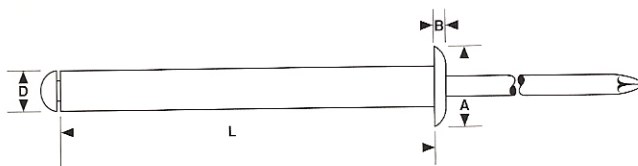

All Dimensions for Metric Series are given in millimeters.

GESIPA manufactures a complete line of metric blind rivets according to DIN7337 standards in 3mm, 4mm, 5mm and 6mm diameters. Material choices include Aluminum/Steel, Steel/Steel, as well as 304 and 316 Alloy Stainless Steel. Listed below are GESIPA's Extra Length Metric Rivets.

Aluminum Rivet/Steel Mandrel

Head Style	Rivet Dia. Nom.	GESIPA Part Number	Grip Range (mm)	Hole Size Drill No.	Dimensions (Millimeters)				Min. Strength (lbs.)	
					D	B Max.	A	L Max.	Shear	Tensile
Dome	3mm	3 X 18F A/S	13-15	3.1-3.2	2.9-3.08	1.2	5.8-6.5	18.8	160	200
		3 X 20F A/S	15-17					20.8		
		3 X 25F A/S	17-22					25.8		
		3 X 30F A/S	22-26					30.8		
	4mm	4 X 18F A/S	12.5-14.5	4.1-4.2	3.85-4.08	1.5	7.0-8.0	19.0	190	225
		4 X 20F A/S	14.5-16.5					21.0		
		4 X 25F A/S	16.5-21.5					26.0		
		4 X 30F A/S	21.5-26					31.0		
		4 X 35F A/S	26-30					36.0		
5mm	5mm	5 X 35F A/S	25-30	5.1-5.2	4.85-5.08	1.6	8.5-9.5	36.0	450	630
		5 X 40F A/S	30-35					41.0		
		5 X 45F A/S	35-40					46.0		
		5 X 50F A/S	40-45					51.0		
		5 X 55F A/S	45-48					56.0		
		5 X 60F A/S	48-52					61.0		
		5 X 65F A/S	52-57					66.0		
		5 X 70F A/S	57-62					71.0		
		5 X 80F A/S	62-72					81.0		

Steel Rivet/Steel Mandrel

Head Style	Rivet Dia. Nom.	GESIPA Part Number	Grip Range (mm)	Hole Size Drill No.	Dimensions (Millimeters)				Min. Strength (lbs.)	
					D	B Max.	A	L Max.	Shear	Tensile
Dome	5mm	5 X 35F S/S 5 X 40F S/S 5 X 45F S/S 5 X 50F S/S	25-30 30-34 34-39 39-44	5.1-5.2	4.85-5.08	1.4	8.5-9.5	36 41 46 51	765	990

Rivet Diameter: 3 X 18 F A / S
 Rivet Length Under Flange: _____
 _____ Mandrel Material
 _____ Rivet Material
 _____ Head Style

Mandrel Material
 A = Aluminum
 S = Steel

Head Style:
 F = Flat "Dome"

POLYGRIP® MULTIGRIP BLIND RIVETS

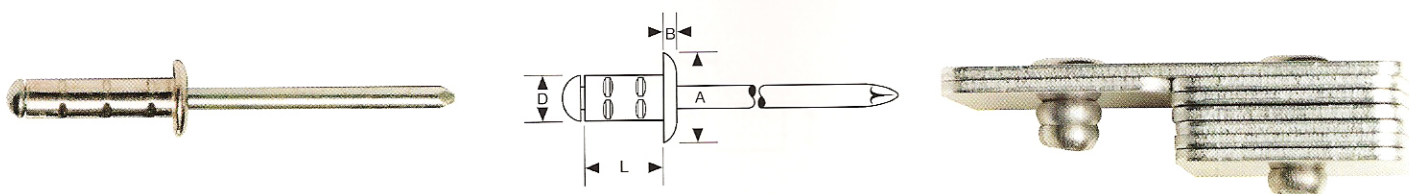

GESIPA PolyGrip rivets feature a wide grip range, enabling a single PolyGrip to replace up to three different lengths of standard blind rivets. PolyGrip rivets expand radially, filling the application hole, resulting in tighter joints and improved sealing. Add to this PolyGrip's locked mandrel core and you have a weather tight rattle resistant fastener. Improved material support is provided by the PolyGrip's larger blindside head formation.

Aluminum Rivet/Steel Mandrel

Head Style	Rivet Dia. Nom.	GESIPA Part Number	Grip Range (Inches)	Hole Size Drill No.	Dimensions (Inches)				Min. Strength (lbs.)	
					D	B Max.	A	L Max.	Shear	Tensile
Dome	1/8"	GSMD41-43APG	.039-.197	.129-.136 #30	.122-.129	.043	.228-.256	.346	162	236
		GSMD42-44APG	.059-.256					.406		
		GSMD43-45APG	.118-.315					.465		
	5/32"	GSMD51-54APG	.039-.256	.161-.166 #20	.151-.160	.051	.276-.315	.433	238	377
GSMD53-56APG		.138-.375	.551							
GSMD55-58APG		.276-.512	.709							
3/16"	GSMD62-64APG GSMD63-67APG GSMD66-68APG GSMD69-612APG GSMD612-615APG	.039-.256	.192-.197 #10	.183-.192	.063	.335-.374	.433	359	510	
		.177-.433					.630			
		.256-.512					.709			
		.433-.768					1.024			
1/4"	GSMD82-86APG GSMD84-89APG GSMD86-811APG	.059-.354	.256-.275 "F"	.246-.255	.087	.453-.512	.630	629	899	
		.236-.551					.827			
		.394-.709					1.024			
Large Flange	1/8"	GSML41-43APG	.039-.197	.128-.133 #30	.122-.129	.063	.335-.374	.346	162	236
		GSML42-44APG	.059-.256					.406		
		GSML43-45APG	.118-.315					.465		
5/32"	GSML51-54APG GSML53-56APG GSML55-58APG	.039-.256	.161-.166 #20	.151-.160	.075	.413-.472	.433	238	377	
		.138-.375					.551			
		.276-.512					.709			
3/16"	GSML62-64APG GSML63-67APG GSML66-68APG GSML69-612APG GSML612-615APG	.039-.256	.192-.197 #10	.183-.192	.087	.571-.630	.433	359	510	
		.177-.433					.630			
		.256-.512					.709			
		.433-.768				1.024				
		.630-.945				1.220				

G S M D 41 - 43 S P G



Mandrel Material:
 A = Aluminum
 S = Steel
 SS = Stainless Steel

Head Styles:
 D = Dome
 L = Large Flange
 C = Countersunk*

* Countersunk Head Style Polygrips available by special order.

POLYGRIP® MULTIGRIP BLIND RIVETS



Aluminum Rivet/Stainless Mandrel

Head Style	Rivet Dia. Nom.	GESIPA Part Number	Grip Range (Inches)	Hole Size Drill No.	Dimensions (Inches)				Min. Strength (lbs.)	
					D	B Max.	A	L Max.	Shear	Tensile
Dome	1/8"	GSSMD41-43APG	.039-.197	.129-.136 #30	.122-.129	.043	.228-.256	.346	162	236
		GSSMD42-44APG	.059-.256					.406		
		GSSMD43-45APG	.118-.315					.465		
	5/32"	GSSMD51-54APG	.039-.256	.161-.166 #20	.151-.160	.051	.276-.315	.433	238	377
GSSMD53-56APG		.138-.375	.551							
GSSMD55-58APG		.276-.512	.709							
3/16"	GSSMD62-64APG	.039-.256	.192-.197 #10	.183-.192	.063	.335-.374	.433	359	510	
	GSSMD63-67APG	.177-.433					.630			
	GSSMD66-68APG	.256-.512					.709			
	GSSMD69-612APG	.433-.768					1.024			
	GSSMD612-615APG	.630-.945					1.220			
1/4"	GSSMD82-86APG	.059-.354	.256-.275 "F"	.246-.255	.087	.453-.512	.630	629	899	
	GSSMD84-89APG	.236-.551					.827			
	GSSMD86-811APG	.394-.709					1.024			
Large Flange	1/8"	GSSML41-43APG	.039-.197	.128-.133 #30	.122-.129	.063	.335-.374	.346	162	236
		GSSML42-44APG	.059-.256					.406		
		GSSML43-45APG	.118-.315					.465		
	5/32"	GSSML51-54APG	.039-.256	.161-.166 #20	.151-.160	.075	.413-.472	.433	238	377
		GSSML53-56APG	.138-.375					.551		
		GSSML55-58APG	.276-.512					.709		
	3/16"	GSSML62-64APG	.039-.256	.192-.197 #10	.183-.192	.087	.571-.630	.433	359	510
		GSSML63-67APG	.177-.433					.630		
		GSSML66-68APG	.256-.512					.709		
GSSML69-612APG		.433-.768	1.024							
GSSML612-615APG		.630-.945	1.220							

Steel Rivet/Steel Mandrel

Head Style	Rivet Dia. Nom.	GESIPA Part Number	Grip Range (Inches)	Hole Size Drill No.	Dimensions (Inches)				Min. Strength (lbs.)								
					D	B Max.	A	L Max.	Shear	Tensile							
Dome	1/8"	GSMD41-43SPG	.039-.197	.129-.136 #30	.122-.129	.043	.228-.256	.354	270	382							
		GSMD42-44SPG	.059-.256					.406									
		GSMD43-45SPG	.118-.315					.465									
	5/32"	GSMD51-54SPG	.039-.256	.161-.166 #20	.151-.160	.051	.276-.315	.433	370	540							
		3/16"	GSMD62-64SPG					.039-.256			.192-.197 #10	.183-.192	.063	.335-.374	.433	584	719
			GSMD63-67SPG					.177-.433							.630		
GSMD66-68SPG		.256-.512					.709										
	Large Flange	1/8"	GSML42-44SPG	.059-.256	.129-.136 #30	.122-.129	.063	.355-.374	.406	270	382						
			3/16"	GSML62-64SPG					.039-.256			.192-.197 #10	.183-.192	.087	.571-.630	.433	584
GSML63-67SPG	.177-.433	.630															
GSML66-68SPG	.256-.512	.709															

Note: Additional sizes of Steel Polygrip are available by special order.

Stainless Rivet/Stainless Mandrel

Head Style	Rivet Dia. Nom.	GESIPA Part Number	Grip Range (Inches)	Hole Size Drill No.	Dimensions (Inches)				Min. Strength (lbs.)	
					D	B Max.	A	L Max.	Shear	Tensile
Dome	1/8"	GSSMD41-43SSPG	.020-.192	.128-.133 #30	.122-.129	.051	.228-.256	.346	326	517
		GSSMD42-44SSPG	.059-.256					.406		
		GSSMD43-45SSPG	.118-.315					.465		
	5/32"	GSSMD51-54SSPG	.020-.256	.161-.166 #20	.151-.160	.051	.276-.315	.433	595	809
		GSSMD53-55SSPG	.139-.354					.551		
		GSSMD55-57SSPG	.276-.472					.709		

DOME PEEL RIVETS

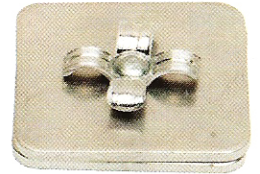
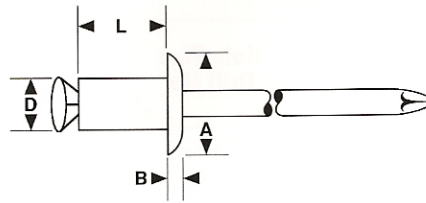

GESIPA Dome Peel rivets split into four legs providing a large blind side bearing head for improved support in brittle, soft or ductile materials.

Aluminum Rivet/Steel Mandrel

Head Style	Rivet Dia. Nom.	GESIPA Part Number	Grip Range (Inches)	Hole Size Drill No.	Dimensions (Inches)				Min. Strength (lbs.)	
					D	B Max.	A	L Max.	Shear	Tensile
Dome	1/8"	GSMD42ADP	.039-.138	.142 #27	.122-.138	.048	.228-.256	.354	180	213
		GSMD43ADP	.098-.197					.433		
		GSMD44ADP	.177-.276					.512		
		GSMD46ADP	.256-.354					.590		
		GSMD47ADP	.335-.433					.669		
5/32"	5/32"	GSMD52ADP	.039-.118	.173 #17	.151-.169	.059	.275-.315	.354	315	450
		GSMD53ADP	.098-.197					.433		
		GSMD54ADP	.177-.256					.512		
		GSMD55ADP	.236-.315					.590		
		GSMD56ADP	.295-.394					.669		
		GSMD58ADP	.354-.422					.748		
		GSMD510ADP	.452-.551					.827		
3/16"	3/16"	GSMD62ADP	.039-.118	.204 #6	.183-.201	.063	.335-.374	.354	450	607
		GSMD63ADP	.098-.197					.433		
		GSMD64ADP	.177-.276					.512		
		GSMD65ADP	.256-.354					.590		
		GSMD66ADP	.335-.394					.669		
		GSMD68ADP	.375-.472					.748		
		GSMD610ADP	.453-.551					.827		
		GSMD612ADP	.531-.748					1.024		

GESIPA _____ G SM D 4 2 A DP
 Mandrel Material _____
 Head Style _____
 _____ Dome Peel
 _____ Rivet Material
 _____ Grip Range
 _____ Rivet Diameter (in 1/32")
 Rivet Material: A=Aluminum
 Mandrel Material: S=Steel
 Head Style: D=Dome

TRI-FOLD RIVETS

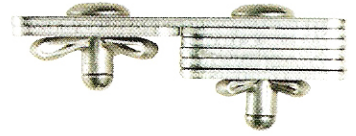
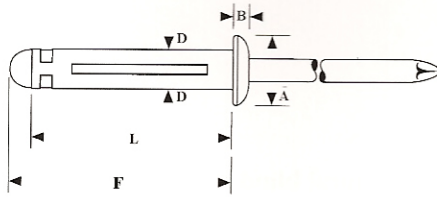

GESIPA Tri-fold rivets form three folded legs that distribute the fasteners' clamp-load over a larger blind side head formation. The larger blind side head prevents cracking of brittle materials and greater pull-through resistance in soft and ductile material applications.

Aluminum Rivet/Aluminum Mandrel

Head Style	Rivet Dia. Nom.	GESIPA Part Number	Grip Range (Inches)	Hole Size Drill No.	Dimensions (Inches)					Min. Strength (lbs.)	
					D	B Max.	A	L Max.	F Max.	Shear	Tensile
Dome	5/32"	GAMD52ATF	.040-.118	.162-.167 #20	.154-.161	.060	.302-.322	.590	.711	150	200
		GAMD54ATF	.040-.250					.790	.911		
		GAMD56ATF	.040-.375					.852	.973		
		GAMD58ATF	.040-.500					.977	1.098		
Dome	3/16"	GAMD64ATF	.040-.189	.199-.213	.187-.197	.080	.375-.395	.775	.905	300	325
		GAMD65ATF	.040-.250					.837	.967		
		GAMD66ATF	.040-.312					.900	1.030		
Dome	3/8"	GAMD68ATF	.040-.500	.209-.221 #4	.195-.205	.080	.375-.395	1.020	1.138	325	375
		GAMD610ATF	.040-.625					1.145	1.263		
		GAMD612ATF	.040-.750					1.270	1.388		



Mandrel Material:
A = Aluminum

Head Style:
D = Dome

Tri-fold rivets are used in automotive applications such as plastic body panels, trim, and interior components

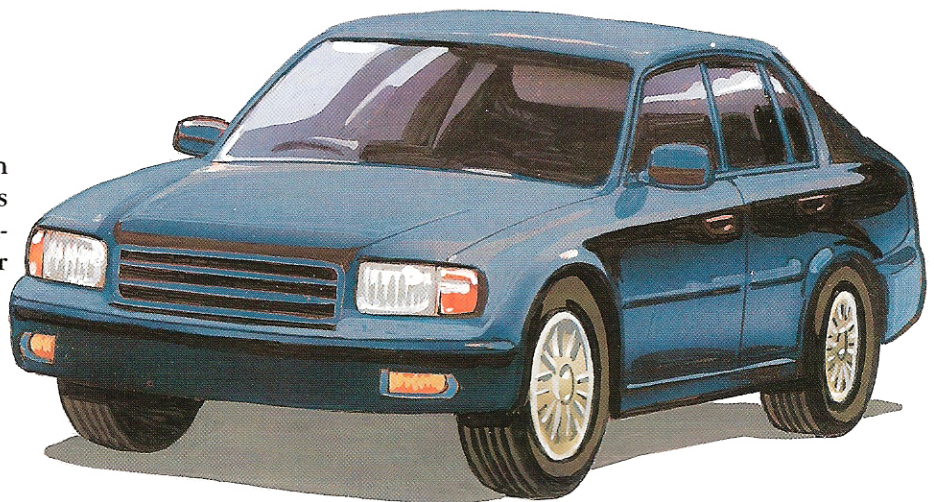

OLYMPIC MEGA-GRIP RIVETS

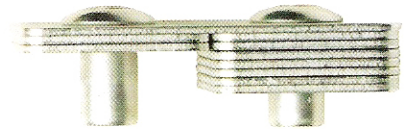
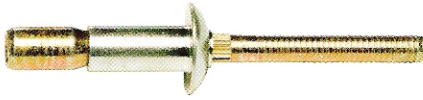

The GESIPA Mega-Grip is a high strength structural blind rivet offering several advantages over conventional blind rivets. Mega-Grip's wide grip range enables a single Mega-Grip to replace up to five different lengths of standard rivets. High shear strength is achieved by Mega-Grips' flush break self plugging mandrel. Mega-Grip rivets are hole-filling, resulting in tighter joints and improved sealing for weather tightness. Mega-Grip rivets are installed via standard rivet tools and do not require special nose tips.

Aluminum Rivet/Aluminum Mandrel

Head Style	Rivet Dia. Nom.	GESIPA Part Number	Grip Range (Inches)	Hole Size Drill No.	Dimensions (Inches)					Min. Strength (lbs.)		
					D	B Max.	A	L Max.	F Max.	Shear	Tensile	Mandrel Pushout
Dome	3/16"	RV6900-6-4 RV6900-6-7XG	.062-.250 .062-.437	.194-.204 #8	.185-.188	.088	.353-.373	.405 .562	.755 1.035	750	600	125
	1/4"	RV6900-8-6 RV6900-8-10XG	.080-.375 .080-.625	.261-.272 H	.253-.257	.108	.480-.500	.560 .785	1.025 1.355	1330	1000	250
Counter-sunk	3/16"	RV6100-6-5 RV6100-6-8	.125-.312 .275-.500	.194-.204 #8	.185-.188	.099	.344-.356	.480 .600		750	600	125
	1/4"	RV6100-8-7 RV6100-8-10	.125-.437 .125-.625	.261-.272 H	.253-.257	.107	.429-.441	.633 .790	1.030 1.320	1330	1000	250
Large Flange	1/4"	RV6500-8-6 RV6500-8-10XG	.080-.375 .080-.625	.261-.204 H	.253-.257	.112	.749-.761	.556 .765	1.020 1.145	1330	1000	250

Steel Rivet/Steel Mandrel

Dome	3/16"	RV6977-6-4 RV6977-6-7XG	.062-.250 .062-.437	.194-.204 #8	.185-.188	.088	.353-.373	.405 .562	.755 1.035	1450	1100	250
	1/4"	RV6977-8-6 RV6977-8-10XG	.080-.375 .080-.625	.261-.272 H	.253-.257	.108	.480-.500	.560 .785	1.025 1.355	3000	1900	500
Counter-sunk	3/16"	RV6177-6-5 RV6177-6-8	.125-.312 .275-.500	.194-.204 #8	.185-.188	.099	.344-.356	.480 .600	.800 1.032	1450	1100	250
	1/4"	RV677-8-7 RV6177-8-10	.125-.437 .125-.625	.261-.272 H	.253-.257	.107	.429-.441	.633 .790	1.200 1.320	3000	1900	500
Large Flange	1/4"	RV6577-8-6 RV6577-8-10XG	.080-.375 .080-.625	.261-.272 H	.253-.257	.112	.749-.761	.556 .765	1.020 1.145	3000	1900	500

RV6 9 0 0 - 8 - 10 XG

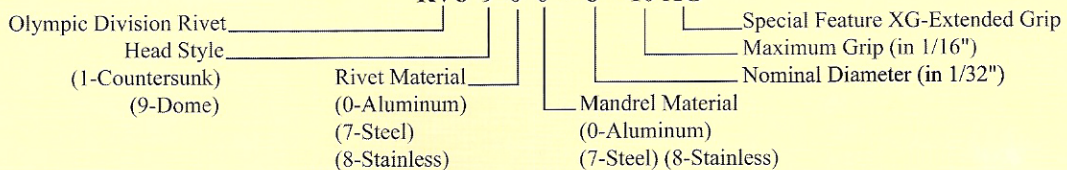

Note: Above values are shown as a guide only and may vary depending upon applications. Shear and tensile strength tests were conducted in hardened alloy steel with a thickness equal to the fastener diameter. Strength values measured in nominal grip.

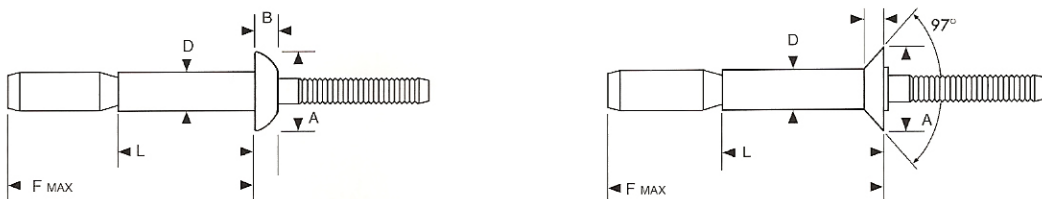

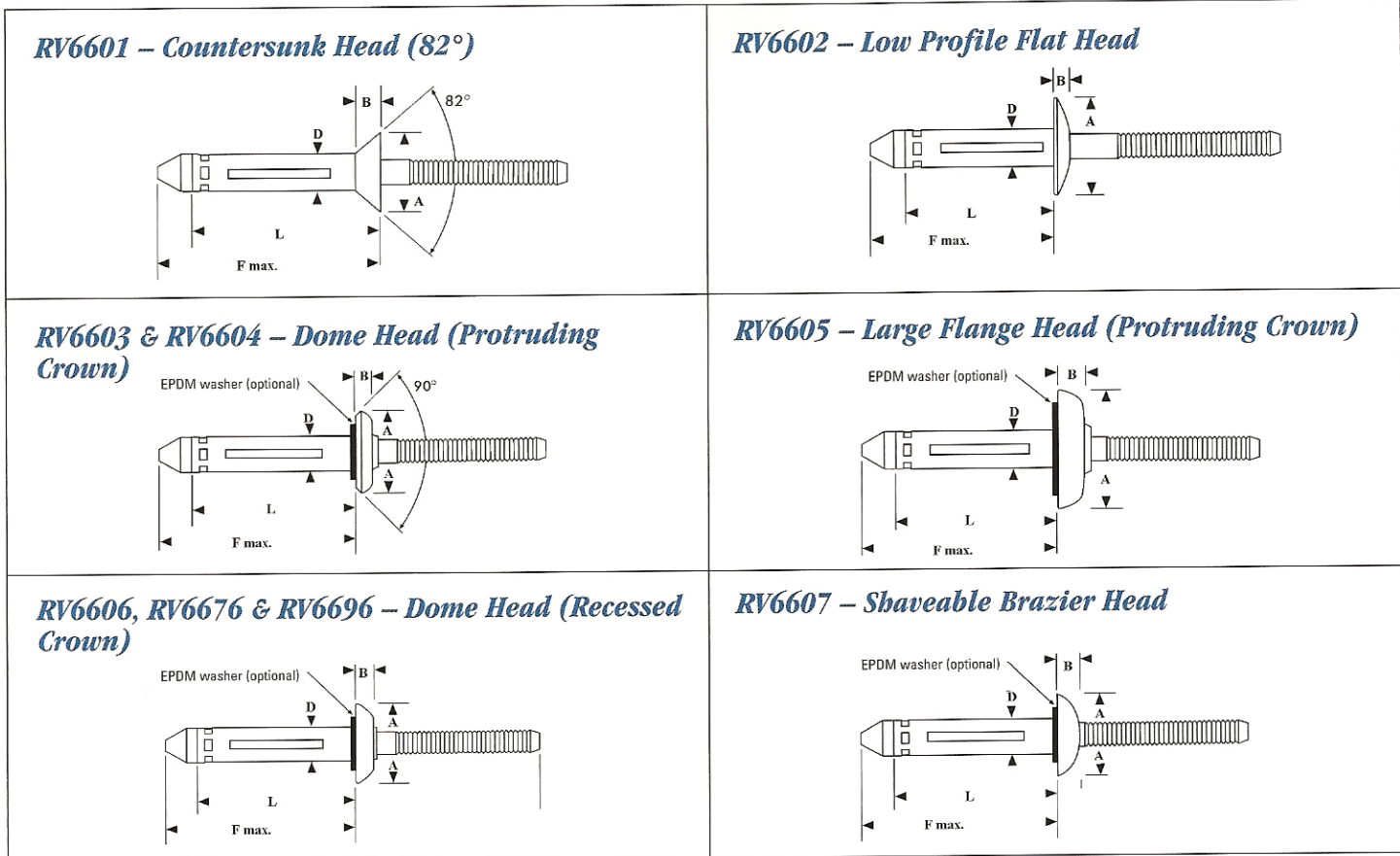

A - Body Diameter • B - Head Height • D - Head Diameter • L - Rivet Body Length • F - Blind Side Protrusion

Aluminum Rivet/Aluminum Mandrel

Head Style	Rivet Dia. Nom.	GESIPA Part Number	Grip Range (Inches)	Hole Size Drill No.	Dimensions (Inches)					Typ. Strengths (lbs.)	
					D Max.	B Max.	A	L Max.	F Max.	Shear	Tensile
Countersunk Head Recessed Crown	3/16"	RV6601-6-4	.106-.250	.209-.221 #4	.195-.205	.103 Ref.	.340 Min.	.770	.935	675	450
		RV6601-6-6	.187-.375					.895	1.060		
		RV6601-6-8	.312-.500					1.020	1.185		
		RV6601-6-10	.437-.625					1.145	1.310		
		RV6601-6-12	.563-.750					1.250	1.435		
1/4"	RV6601-8-4	.150-.250	.250-.263 E	.246	.147 Ref.	.452 Min.	.815	1.005	1100	675	
	RV6601-8-6	.187-.375					.940	1.130			
	RV6601-8-8	.250-.500					1.065	1.255			
Low Profile Flat Head	5/32"	RV6602-5-4	.125-.250	.162-.167 #20	.161 Max.	.359-.375	.790	.862	350	225	
		RV6602-5-6	.187-.375				.852	.987			
		RV6602-5-8	.250-.500				.977	1.112			
	3/16"	RV6602-6-4	.125-.250	.209-.221 #4	.195-.205	.062	.430-.455	.770	.935	675	450
		RV6602-6-6	.187-.375					.895	1.060		
		RV6602-6-8	.250-.500					1.020	1.185		
		RV6602-6-10	.375-.625					1.145	1.310		
		RV6602-6-12	.500-.750					1.270	1.435		
	1/4"	RV6602-8-4	.125-.250	.250-.263 1/4"	.246	.070	.532-.542	.795	1.005	1100	675
		RV6602-8-6	.187-.375					.940	1.130		
		RV6602-8-8	.250-.500					1.065	1.255		
		RV6602-8-10	.375-.625					1.190	1.360		

Aluminum Rivet/Aluminum Mandrel

Head Style	Rivet Dia. Nom.	GESIPA Part Number	Grip Range (Inches)	Hole Size Drill No.	Dimensions (Inches)					Typ. Strengths (lbs.)			
					D Max.	B Max.	A	L Max.	F Max.	Shear	Tensile		
Dome Head Protruding Crown	5/32"	RV6604-5-4 RV6604-5-8	.067-.250 .250-.500	.162-.167 #20	.161 Max.	.074	.335-.350	.785 .972	.925 1.112	350	225		
	3/16"	RV6604-6-3 RV6604-6-4 RV6604-6-6 RV6604-6-8 RV6604-6-10 RV6604-6-12	.050-.187 .062-.250 .187-.375 .312-.500 .437-.625 .563-.750	.209-.221 #4	.195-.205	.125	.430-.455	.707 .770 .895 1.020 1.145 1.270	.844 .907 1.032 1.157 1.282 1.407	675	450		
		1/4"	RV6604-8-4 RV6604-8-6 RV6604-8-8 RV6604-8-10	.062-.250 .125-.375 .250-.500 .375-.625	.250-.263 1/4	.246 Max.	.118	.555-.565	.815 .940 1.065 1.190	1.005 1.130 1.255 1.360	1100	675	
			9/32"	RV6603-9-3 RV6603-9-6 RV6603-9-10 RV6603-9-12	.032-.187 .032-.375 .250-.625 .375-.750	.308-.327 5/16	.295-.304	.150	.610-.620	0.863 1.110 1.360 1.485	1.000 1.325 1.575 1.700	1500	1100
9/32"				RV6605-9-6 RV6605-9-10 RV6605-9-12	.042-.375 .250-.625 .375-.750	.308-.327 5/16	.295-.304	.150	.720-.765	1.110 1.360 1.485	1.325 1.575 1.700	1500	1100
				3/16"	RV6606-6-3 RV6606-6-4 RV6606-6-6 RV6606-6-8 RV6606-6-10 RV6606-6-12	.050-.187 .062-.250 .187-.375 .312-.500 .437-.625 .563-.750	.209-.221 #4	.195-.205	.099	.446-.492	.707 .770 .895 1.020 1.145 1.270	.844 .907 1.032 1.157 1.282 1.407	675
	1/4"	RV6606-8-4 RV6606-8-6 RV6606-8-8 RV6606-8-10			.040-.250 .125-.375 .250-.500 .375-.625	.250-.263 1/4	.246 Max.	.116	.535-.550	.815 .940 1.065 1.190	1.005 1.130 1.255 1.380	1100	675

Steel Rivet/Steel Mandrel

Countersunk Head Recessed Crown	1/4"	RV6671-8-4 RV6671-8-6 RV6671-8-8	.150-.250 .187-.375 .250-.500	.250-.263 1/4	.246 Max.	.147 Ref.	.477-.485	.915 1.040 1.165	1.005 1.130 1.355	1250	950
Dome Head Recessed Crown	1/4"	RV6676-8-4 RV6676-8-6 RV6676-8-8 RV6676-8-10	.040-.250 .125-.375 .250-.500 .375-.625	.250-.263 1/4	.246 Max.	.116	.535-.550	.815 .940 1.065 1.190	1.005 1.130 1.255 1.380	1250	950

Monel Rivet/Stainless Steel Mandrel

Dome Head Recessed Crown	1/4"	RV6696-8-4 RV6696-8-6 RV6696-8-8 RV6696-8-10	.040-.250 .125-.375 .250-.500 .375-.625	.250-.263 1/4	.246 Max.	.116	.535-.550	.815 .940 1.065 1.190	1.005 1.130 1.255 1.360	2100	1455
--------------------------	------	---	--	------------------	--------------	------	-----------	--------------------------------	----------------------------------	------	------

RV66 0 4 - 6 - 8 W

Olympic Bulb-Tite _____

Rivet Material _____

0 - Aluminum

7 - Steel

9 - Monel

Washer for Weather Resistance _____

Maximum Grip (in 1/16") _____

Nominal Diameter (in 1/32") _____

Head Style _____

1 - Countersunk

2 - Flat Head

3 & 9 - Dome Head (Protruding Crown)

4 - Dome Head (Protruding Crown)

5 - Large Flange Head

6 - Dome Head (Recessed Crown)

7 - Dome Head (Shaveable)

Head Style	Rivet Dia. Nom.	GESIPA Part Number	Grip Range	Hole Size Drill No.	Dimensions (Inches)					Typ. Strengths (lbs.)	
					D	B Max.	A	L Max.	F Max.	Shear	Tensile
Shaveable Brazier Head	5/32"	RV6607-5-5	.020-.312	.162-.167 #20	.161 Max.	.077	.296-.328	.800	.920	350	225
	3/16"	RV6607-6-3	.020-.187	.209-.221 #4	.195-.205	.105	.446-.492	.707	.839	675	450
		RV6607-6-4	.500-.250					.770	.935		
		RV6607-6-6	.050-.375					.895	1.060		
RV6607-6-8		.050-.500		1.020				1.185			
RV6607-6-10	.500-.625		1.145	1.310							
RV6607-6-12	.500-.750		1.270	1.435							
1/4"	RV6607-8-8	.050-.500	.250-.263 1/4	.246 Max.	.125	.446-.492	1.065	1.255	1100	675	

Shaveable Series

The Shaveable series of Bulb-tite rivets are designed for use in applications where solid "bucked" type rivets are commonly used such as truck/trailer body assembly or repair. The Shaveable Bulb-tite simplifies repairs made to solid riveted assemblies, as rivet replacement does not require access to the blind side of the application. The Bulb-tite's large blindside footprint functions well in rivet holes that have become elongated or too large to allow use of a solid rivet. Simply install the Bulb-tite and finish the rivet head with an Olympic head-shaving tool. The shaved head profile perfectly matches the solid brazier head rivets used elsewhere in the assembly. Shaveable Bulb-tites are available in 5/32", 3/16" and 1/4" diameters and can be installed with most standard blind rivet tools. A special tool nose tip is not required. The installed rivet's mandrel is designed to break high, leaving an exposed mandrel plug extending above the set fastener's head. The remaining mandrel protrusion is snipped off using the RV57 mandrel trimming tool. Finally, the rivet head is shaved using the HS310 rivet head shaver, leaving a finished rivet head that matches solid rivets in appearance.

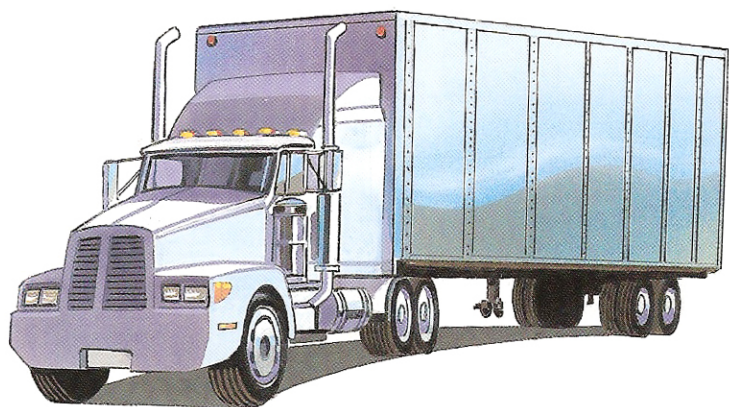

1. PROTRUDING MANDREL IS SNIPPED FLUSH WITH RIVET'S HEAD.

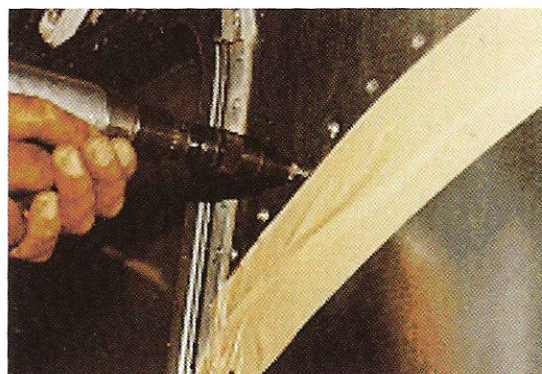

2. PROPER SIZED SHAVER TOOL, INSTALLED IN A STANDARD 1/4" DRILL, SHAVES RIVET HEAD.

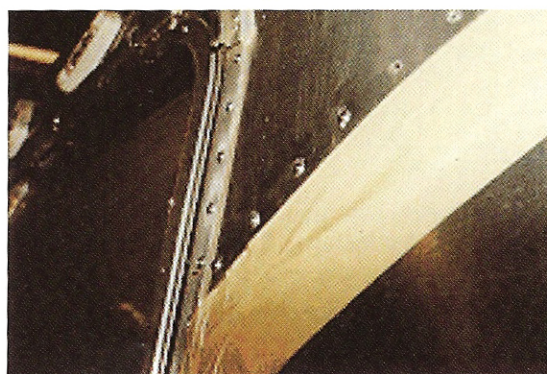

3. SHAVED BULB-TITE RIVETS MATCH SOLID RIVETS PERFECTLY!