

Cordless Blind Riveter

POWERFUL

VERSATILE

LIGHTWEIGHT

PRODUCTIVE



**Fast & Efficient....
Rivals air powered
Performance**

**Built In Overload
Protection**

Ergonomically Balanced

The New, Higher Capacity PT-4000 Cordless Blind Riveter offers the sheet metal technician capability for installation of most all 1/4" diameter blind rivets while retaining all the features of the PT-3000 with respect to size, weight and versatility. Falling within the USAF To-1-1-688 spec, the PT-4000 develops in excess of 3,000 lbs of pulling force over more than 3/4" of stroke. Utilizing the same battery packs and charger as the PT-3000 riveter, the PT-4000 is a logical addition for any organization normally requiring 1/4" diameter blind riveting capability.

PT-4000 Specifications

| | |
|---|---|
| Pulling Force: | 3,000 lbs. |
| Stroke: | .787" |
| Dimensions: | 11-7/8" H x 10-3/8" L x 2-5/8" W |
| Power Source: | 3.2 Ah, 12vdc Nickel-Metal (NiMH) Hydride Battery |
| Charger Source: | 120 volt, 60 Hz or 220 volt, 50 Hz |
| Charger Cycle Time: | 1 Hour |
| Operating Temp. Range (ambient): | 32 to 120°F |
| Housing Material: | Impact Resistant Glass Filled Nylon |

P.O. Box 1372
1206 E. MacArthur St.
Sonoma, CA 95476
1-800-344-2393
(707) 935-1170
FAX: (707) 935-1828
CAGE Code: 64878
www.fsirivet.com
Email: sales@fsirivet.com

PT-4000-MIL-1 Configurations

Standard Configuration

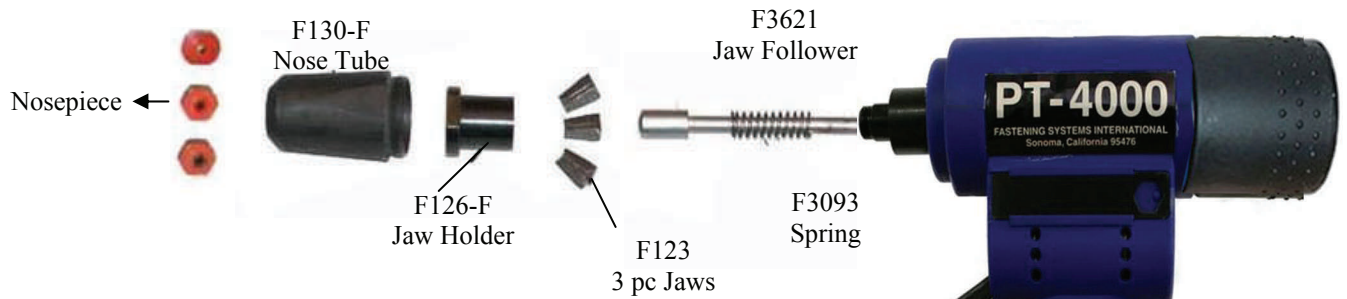

CherryMax® Pulling Head (optional) Configuration

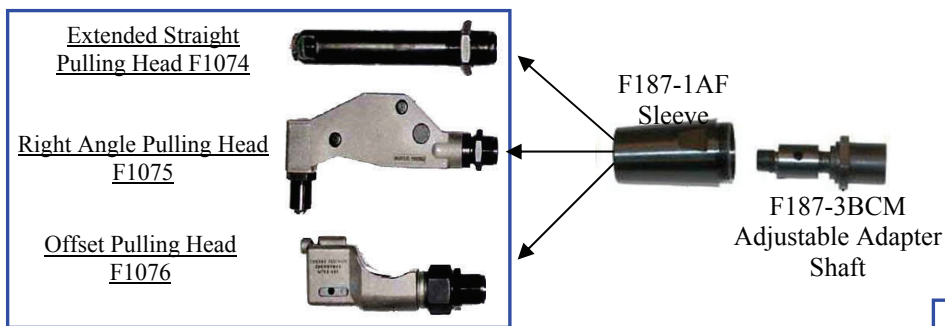

Rivet Types:

Types of rivets installable with the PT-4000 include, but are not limited to, virtually all CherryMax® (M7885), Avdel®, or Cherry Mono-bolts®, Cherry Interlock®, Huck MagnaLok®, and Pop type rivets. The PT-4000 is also capable of installing both 5/32" and 3/16" Blind Bolts (MS90353/54-S/U) with the proper nosepieces (provided in the Mil-1 and MIL-2 kits).

PT-4000 Features:

- ▶ **Powerful:** Installs Virtually all Straight Pull Blind Rivets including **CherryMax®** style (M7885) thru 3/16" diameter and most 1/4" diameter all Aluminum Blind Rivets
- ▶ **Ergonomically Balanced:** Helps minimize RTD's (repetitive trauma disorders) associated with most Hand Pump or Squeeze Type Riveters typically used in remote locations where power is not readily available
- ▶ **Over 3/4" Stroke:** Permits installation of most Blind Rivets in one cycle
- ▶ **Operating Temperature Protection:** Riveter automatically shuts down if overheated
- ▶ **Quick Charge Battery Pack:** One hour recharge
- ▶ **Positive Stroke Control:** Operator can re-grip rivet as many times as necessary
- ▶ **Built In Overload Protection:** Riveter automatically shuts down if used improperly
- ▶ **No Stem Jamming:** If battery discharges while riveting, riveter will always retain sufficient power to return full forward position

