

PT-4000-MIL-2 UNIVERSAL CORDLESS BLIND RIVETER

POWERFUL

VERSATILE

LIGHTWEIGHT

PRODUCTIVE

**Fast & Efficient....
Rivals air powered
Performance**

**Ergonomically
Balanced**

**Box 1372
1206 E. MacArthur St.
Sonoma, CA 95476
1-800-344-2393
(707) 935-1170
FAX: (707) 935-1828
CAGE Code: 64878
www.fsirivet.com
sales@fsirivet.com**

 Contract #
GS-06F-0009L



The **PT-4000** can install virtually all CherryMax® (M7885), Avdel® or Cherry Monobolts®, Cherry Interlock®, Huck MagnaLok® and Pop® type rivets. It is also capable of installing both 5/32" and 3/16" Blind Bolts (MS90353/54 S/U) with the proper nosepieces provided in the PT-4000-MIL-2 kit. The riveter can be easily adapted for special right angle, offset and extended straight CherryMax® (M7885) pulling heads, as well as the special right angle pulling head for the 1/4" CherryMax® and 3/16" Blind Bolts (MS90353/54 S/U).

The New, Higher Capacity PT-4000 Cordless Blind Riveter offers the sheet metal technician capability for installation of most all 1/4" diameter blind rivets while retaining all the features of the PT-3000 with respect to size, weight and versatility. Falling within the USAF To-1-1-688 spec, the PT-4000 develops in excess of 3,000 lbs of pulling force over more than 3/4" of stroke. Utilizing the same battery packs and charger as the PT-3000 riveter, the PT-4000 is a logical addition for any organization normally requiring 1/4" diameter blind riveting capability.

PT-4000-MIL-2 Configurations

Standard Configuration

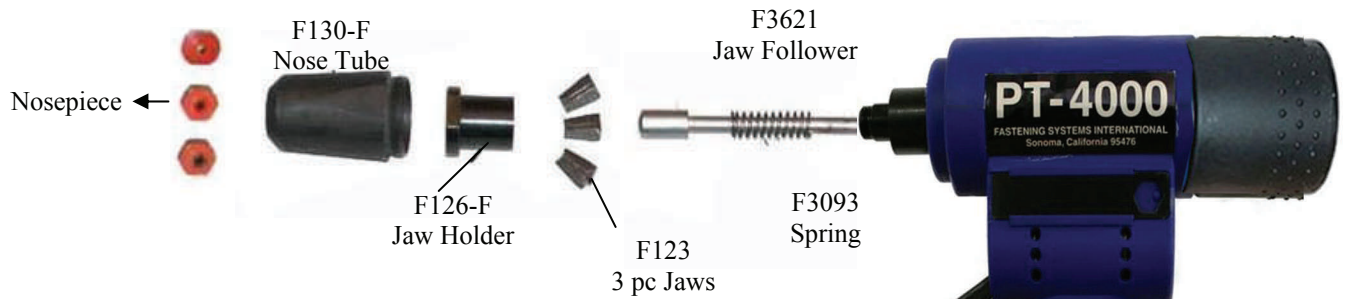

CherryMax® Pulling Head Configuration

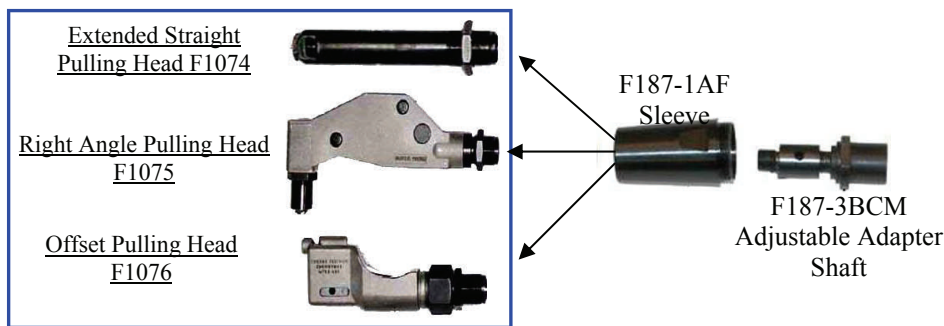

PT-4000 Features:

- ▶ **Powerful:** Installs Virtually all Straight Pull Blind Rivets including **CherryMax®** style (M7885) thru 3/16" diameter and most 1/4" diameter all Aluminum Blind Rivets
- ▶ **Over 3/4" Stroke:** Permits installation of most Blind Rivets in one cycle
- ▶ **Quick Charge Battery Pack:** One hour recharge
- ▶ **Built In Overload Protection:** Riveter automatically shuts down if used improperly
- ▶ **Ergonomically Balanced:** Helps minimize **RTD's** (repetitive trauma disorders) associated with most Hand Pump or Squeeze Type Riveters typically used in remote locations where power is not readily available
- ▶ **Operating Temperature Protection:** Riveter automatically shuts down if overheated
- ▶ **Positive Stroke Control:** Operator can re-grip rivet as many times as necessary
- ▶ **No Stem Jamming:** If battery discharges while riveting, riveter will always retain sufficient power to return full forward position

PT-4000 Specifications

Pulling Force:	3,000 lbs. (13.4 KN)
Stroke:	.787" (20.2 mm)
Dimensions:	11-7/8" H x 10-3/8" L x 2-5/8" W (304.5 mm H x 266 mm L x 67.3 mm W)
Power Source:	3.2 Ah, 12vdc Nickel-Metal (NiMH) Hydride Battery
Charger Source:	120 volt, 60 Hz or 220 volt, 50 Hz
Charger Cycle Time:	1 Hour
Operating Temp. Range (ambient):	32 to 120°F (0°-49°C)
Housing Material:	Impact Resistant Glass Filled Nylon