

**POWERFUL**

**VERSATILE**

**LIGHTWEIGHT**

**PRODUCTIVE**



**Aerospace**  
**and**  
**Industrial**  
**Sheet Metal**  
**Applications**

**I**f you need to Blind Rivet the cowl of a jet aircraft, the galley in a nuclear submarine, a HMMWV body panel, the tail boom of a helicopter, or the air conditioning duct in an office building and you are in a remote location without convenient power sources, the PT-3000 will help make your blind riveting job go quicker, easier and more cost effective than any other system.

Falling within the scope of the USAF To-1-688 specification, the PT-3000 is now being used for routine aircraft sheet metal repair in any area where 12 VDC portable equipment is permitted. Developing in excess of 1,900 lbs of pulling force, the PT-3000 is able to install virtually all straight pull blind rivets from 3/32" thru 3/16" diameter and even some all aluminum 1/4" diameters.

P.O. Box 1372  
1206 E. MacArthur St.  
Sonoma, CA 95476  
1-800-344-2393  
(707) 935-1170  
FAX: (707) 935-1828  
CAGE Code: 64878  
www.fsirivet.com  
sales@fsirivet.com

**Specifications for PT-3000:**

<b>Pulling Force:</b>	1,900 lbs.
<b>Stroke:</b>	.787"
<b>Dimensions:</b>	11-7/8" H x 10-3/8" L x 2-5/8" W
<b>Power Source:</b>	3.2 Ah, 12 vdc Nickel-Metal (NiMH) Hydride Battery
<b>Charger Source:</b>	120 volt, 60 Hz or 220 volt, 50 Hz
<b>Charger Cycle Time:</b>	1 Hour
<b>Operating Temp. Range (ambient):</b>	32 to 120°F
<b>Housing Material:</b>	Impact Resistant Glass Filled Nylon

# PT-3000-MIL-1 Configuration

## Standard Configuration

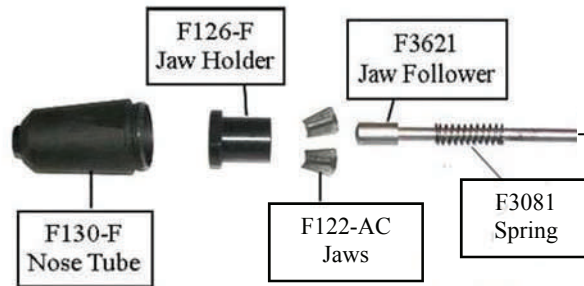

## Rivet Types:

Both aerospace and industrial quality blind rivets are installable with the PT-3000 which include, but are not limited to, CherryMax® (M7885), nut plate rivets, self plugging rivets (MS20600), CherryMax "A"® (NAS1400A), Avdel® MBC (NAS1722L), Cherry Interlock® and Huck Magna-Lok® (M7885/10), Cherry and Avdel Monobolts®, Avdel®, Avex® and standard Pop type rivets (MIL-R-24243). In addition, a wide variety of nosepieces are available to satisfy specific customer needs.

**Over 1900 lbs of Pulling Force**

## PT-3000 Features:

- ▶ **Powerful:** Installs Virtually all Straight Pull Blind Rivets including **CherryMax®** style (M7885) thru 3/16" diameter and most 1/4" diameter all Aluminum Blind Rivets
- ▶ **Ergonomically Balanced:** Helps minimize RTD's (repetitive trauma disorders) associated with most Hand Pump or Squeeze Type Riveters typically used in remote locations where power is not readily available
- ▶ **Over 3/4" Stroke:** Permits installation of most Blind Rivets in one cycle
- ▶ **Operating Temperature Protection:** Riveter automatically shuts down if overheated
- ▶ **Quick Charge Battery Pack:** One hour recharge
- ▶ **Positive Stroke Control:** Operator can re-grip rivet as many times as necessary
- ▶ **Built In Overload Protection:** Riveter automatically shuts down if used improperly
- ▶ **No Stem Jamming:** If battery discharges while riveting, riveter will always retain sufficient power to return full forward position

**Pulls Most All Blind Rivets through 3/16" diameter including CherryMax®**

**More than 3/4" Stroke**