

# Data and dimensions

Small Diameter Bullet Head Blind Rivet

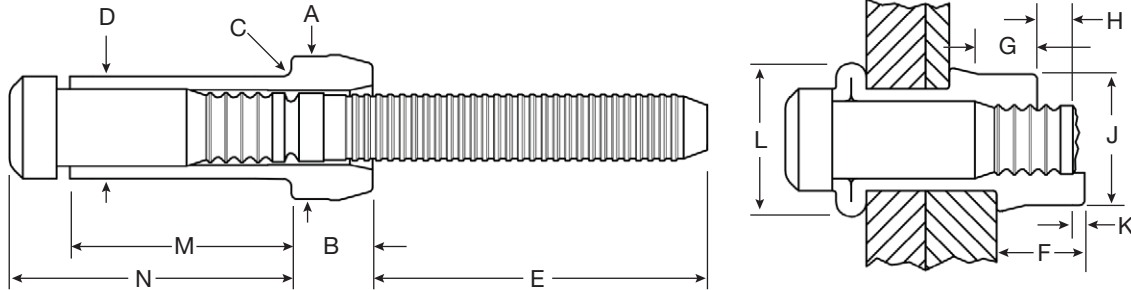

## Dimensional Data

Dia.	Dia	Hole Size	A	B	C Max	D	E Min
3/16"	(6)	.208-.222	0.276 - 0.286	0.152 - 0.168	0.015	0.196 - 0.206	0.785
1/4"	(8)	.277 - .292	0.368 - 0.380	0.205 - 0.225	0.020	0.262 - 0.275	0.860
5/16"	(10)	.348 - .368	0.468 - 0.478	0.266 - 0.278	0.025	0.332 - 0.346	1.285
3/8"	(12)	.413-.435	0.553 - 0.563	0.315 - 0.327	0.030	0.393 - 0.411	1.230
1/2"	(16)	.546 - .581	0.740 - 0.755	0.415 - 0.438	0.035	0.529 - 0.544	1.530
5/8"	(20)	.687 - .728	0.925 - 0.941	0.507 - 0.545	0.040	0.662 - 0.685	1.710
3/4"	(24)	.828 - .873	1.110 - 1.130	0.637 - 0.654	0.050	0.795 - 0.816	2.150

## Inspection Data

Dia.	F Nom	G Min	H Max	J Max	K Max	L Nom
3/16"	0.177	0.109	0.094	0.261	0.031	0.306
1/4"	0.232	0.156	0.094	0.346	0.031	0.405
5/16"	0.300	0.187	0.171	0.434	0.046	0.517
3/8"	0.360	0.203	0.171	0.510	0.046	0.605
1/2"	0.475	0.297	0.171	0.686	0.063	0.841
5/8"	0.595	0.406	0.313	0.874	0.078	1.038
3/4"	0.722	0.438	0.313	1.027	0.078	1.267



## Grip Data

	Grip No.	Grip Range	M Nom	N Max		Grip No.	Grip Range	M Nom	N Max	
6 (3/16")	2	.093 -.156	.376	.500	12 (3/8")	4	.188 -.312	.766	.975	
	3	.157 -.219	.439	.562		6	.313 -.437	.891	1.100	
	4	.220 -.281	.501	.625		8	.438 -.562	1.016	1.225	
	5	.282 -.344	.564	.687		10	.563 -.687	1.141	1.350	
	6	.345 -.406	.626	.750		12	.688 -.812	1.266	1.475	
	7	.407 -.469	.689	.812		14	.813 -.937	1.391	1.600	
	8	.470 -.531	.751	.875		16	.938 -1.062	1.516	1.725	
	9	.532 -.594	.814	.937		18	1.063 -1.187	1.641	1.850	
	10	.595 -.656	.876	1.000		20	1.188 -1.312	1.766	1.975	
	11	.657 -.719	.939	1.062		16 (1/2")	4	.251 -.375	1.000	1.266
	12	.720 -.781	1.001	1.125			6	.376 -.500	1.125	1.391
	8 (1/4")	2	.093 -.156	.460			.625	8	.501 -.625	1.250
3		.157 -.219	.523	.688	10		.626 -.750	1.375	1.641	
4		.220 -.281	.585	.750	12		.751 -.875	1.500	1.766	
5		.282 -.344	.648	.813	14		.876 -1.000	1.625	1.891	
6		.345 -.406	.710	.875	16		1.001 -1.125	1.750	2.016	
7		.407 -.469	.773	.938	18		1.126 -1.250	1.875	2.141	
8		.470 -.531	.835	1.000	20		1.251 -1.375	2.000	2.266	
9		.532 -.594	.898	1.063	22		1.376 -1.500	2.125	2.391	
10		.595 -.656	.960	1.125	24		1.501 -1.625	2.250	2.516	
11		.657 -.719	1.023	1.188	20 (5/8")		4	.251 -.500	1.213	1.531
12		.720 -.781	1.085	1.250		8	.501 -.750	1.463	1.781	
13		.782 -.843	1.147	1.313		12	.751 -1.000	1.713	2.031	
14		.844 -.905	1.209	1.375		16	1.001 -1.250	1.963	2.281	
						20	1.251 -1.500	2.213	2.531	
10 (5/16")	4	.188 -.312	.695	.875	24 (3/4")	4	.251 -.500	1.380	1.750	
	5	.250 -.375	.758	.938		8	.501 -.750	1.630	2.000	
	6	.313 -.437	.820	1.000		12	.751 -1.000	1.880	2.250	
	8	.438 -.562	.945	1.125		16	1.001 -1.250	2.130	2.500	
	10	.563 -.687	1.070	1.250						
	12	.688 -.812	1.195	1.375						
	14	.813 -.937	1.320	1.500						
	16	.938 -1.062	1.445	1.625						

## Installed Values in Nominal Grip (lbs.)

Diameter	Shear	Tensile	<i>Note: These are minimum ultimate shear and tensile strengths, in pounds, of installed fastener, when tested in a grip equal to or greater than one and one half the fastener diameter.</i>
3/16"	2800	1800	
1/4"	5100	3250	
5/16"	8050	5200	
3/8"	11100	7250	
1/2"	20150	13000	
5/8"	28500	20500	
3/4"	45100	29100	